

TM 9-6115-545-24P  
TO 35C2-3 444 4  
NAVFAC P-8-626-24P  
SL-400038G/07499A

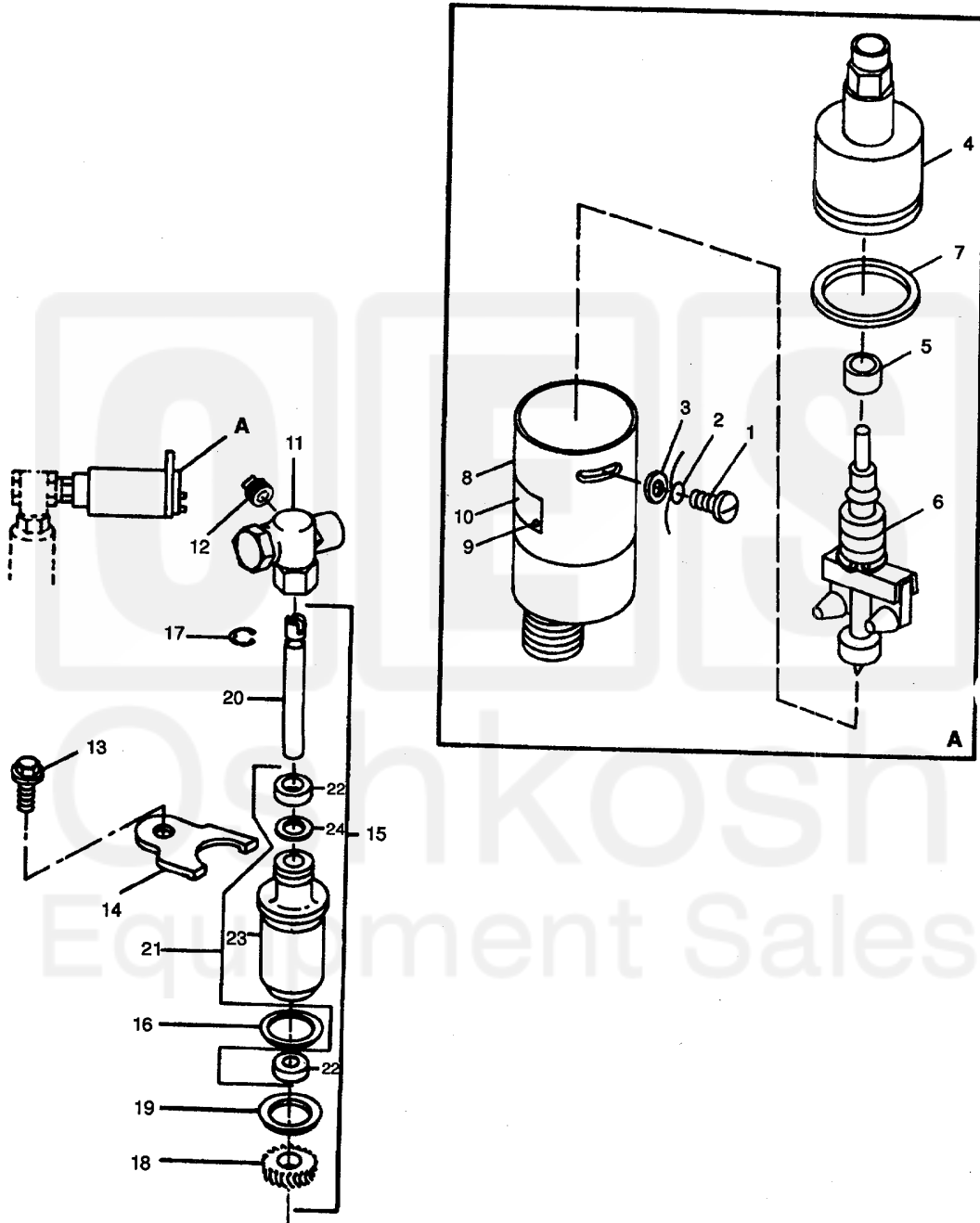

Figure 89. Speed Switch and Tachometer Drive.

TM 9-6115-54524P  
TO 35C2-3 44 4  
NAVFAC P626-24P  
SL-400038G/07499A

(1) ILLUSTRATION		(2) SMR CODE				(3) USMC		(4) NATIONAL STOCK NUMBER	(5) DESCRIPTION			(6)	(7)	(8)
(a) FIG NO.	(b) ITEM NO.	a ARMY	b AIR FORCE	c NAVY	d USMC	a SSI	b REPL FACTOR	REF NUMBER	MFR CODE	USABLE ON CODE	U/M	QTY INC IN UNIT	USMC QTY PER EQUIP	
89		PAOZZ	PAOOO	PAOGG	PAFFF			5930-00-430-540						
									SPEED SWITCH AND TACHOMETER DRIVE					
89		PAOZZ	PAOOO	PAGZZ	PAFFF			5930-01-021-9378	(30554) ABDE (78388)		EA	1	1	
									SWITCH, OVERSPEED 70-1105-2					
89	1	PAFZZ	PAOZZ	XCGZZ	PAFZZ	D	.008	53054-00-218-5757	(30554) CF (78388)		EA	1	1	
									SA897-3DOB SWITCH, OVERSPEED 70-1105-1					
89	2	XBFZZ	XB	XBFZZ	XAFZZ	-			(78388)		EA	1	1	
									SE1045-A LOCKWIRE					
89	3	PAFZZ	PAOZZ	XBGZZ	PAFZZ	D	010	5310-00-515-8058	(78388)		EA	1	1	
									ST89 WASHER FLAT					
89	4	XAFZZ	XA	XAGZZ	XAFZZ				(88044)		EA	3	11	
									AN960-8 BODY ASSY					
89	5	XAFZZ	XA	XAGZZ	XAFZZ				(78388)		EA	1	1	
									SB900 SPACER					
89	6	XAFZZ	XA	XAGZZ	XAFZZ				(78388)		EA	1	1	
									SE402 ROTOR ASSY					
89	7	PAFZZ	PAOZZ	XBGZZ	PAFZ	-	.060	5330-00-807-8993	(78388)		EA	1	1	
									SB776E PACKING, PREFORMED					
89	8	XAFZZ	XA	XBGZZ	MDOZZ	-	.060		(96906)		EA	1	1	
									MS28775-228 SWITCH, CENTRIFUGAL					
89	9	XBOZZ	XB	XBGZZ	XBFZZ				(78388)		EA	1	1	
									SB1014E SCREW, MACHINE					
89	10	XCOZZ	XC	XCGZZ	MDOZZ				(78388)		EA	1	1	
									SE117A PLATE, IDENTIFICATION					
89	11	PAFZZ	PAOZZ	XBGZZ	PAFZZ			3040-00-001-7830	(78388)		EA	1	1	
									SE122 ADAPTER, SPEEDOMETER					
89	12	PAFZZ	PAOZZ	PAGZZ	PAHZZ	-	008	4730-00-8066814	(6N299)		EA	1	1	
									4389859-2 PLUG, PIPE					
89	13	PAFZZ	PAOZZ	XBGZZ	PAFZZ	D	008	53054-00-24-6249	(30554) (30780)		EA	1	1	
									70-1629 1-8HHP-S					
89	14	XBFZZ	XB	XBGZZ	XBFZZ				(6N299)		EA	1	1	
									SCREW, CAP HEX HD 4027690					
89	15	PAFZZ	PAOOO	XBGZZ	PAFHH	I	.120	2990-00-779-9795	(6N299)		EA	1	1	
									402805 DRIVE ASSY					
89	16	PAFZZ	PAOZZ	XBGZZ	PAHZZ	-	.020	5330-00-213-8904	(6N299)		EA	1	1	
									4028805 PACKING, PREFORMED					
89	17	PAFZZ	PAOZZ	XBGZZ	PAHZZ	-	.008	5365-00-461-0473	(6N299)		EA	1	1	
									0923576 RING, RETAINING					
89	18	PAFZZ	PAOZZ	XBGZZ	PAFZZ			3020-00-762-1358	(6N299)		EA	1	1	
									4255932 GEAR, HELICAL					
89	19	PAFZZ	PAOZZ	XBGZZ	PAHZZ	D	.010	3120-00-001-4993	(6N299)		EA	1	1	
									4028808 BEARING, WASHER, THRUST					
89	20	PAFZZ	PAOZZ	XBGZZ	PAHZZ	-	020	2990-00-780-0152	(6N299)		EA	1	1	
									4028809 SHAFT, SHOULDERED					
89	21	PAFZZ	PAOZZ	XBGZZ	PAFZZ			2990-00-780-0779	(6N299)		EA	1	1	
									4028807 HOUSING ASSY					
89	22	XBFZZ	XA	XBGZZ	XBFZZ				(6N299)		EA	2	2	
									4028810 BUSHING					
89	23	XAFZZ	XA	XBGZZ	XAFZZ				(6N299)		EA	1	1	
									4027561 HOUSING					
89	24	PAFZZ	PAOZZ	PAGZZ	PAFZZ	I	.020	5330-00-001-4938	(6N299)		EA	1	1	
									4028806 PACKING, PREFORMED					
									0923865					